



ANIMATING THE RIDEAU CANAL

ANIMER LE CANAL RIDEAU

PRESENTED BY

PRÉSENTÉ PAR

STUDENTS FROM THE
SCHOOL OF URBAN AND
REGIONAL PLANNING

QUEEN'S UNIVERSITY



INTRODUCTION

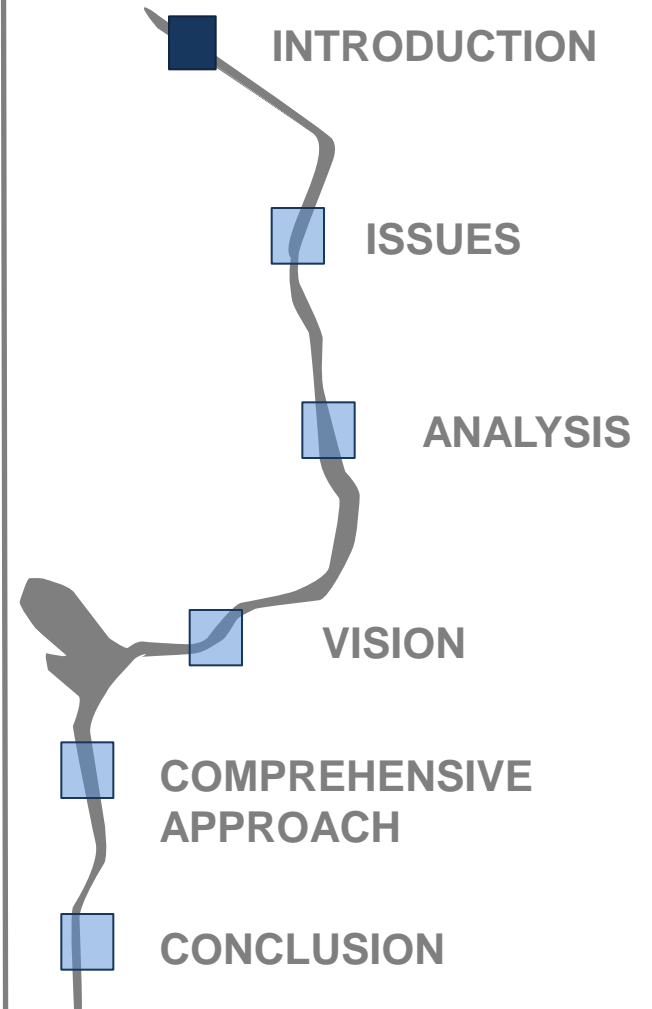



THE CHALLENGE

Our aim is to generate creative ideas for improving urban life along the Rideau Canal.

How do we better connect the Rideau Canal to its surrounding neighborhoods and to the lives of Ottawa's citizens?

THE CHALLENGE

Our aim is to generate creative ideas for improving urban life along the Rideau Canal.

How do we better connect the Rideau Canal to its surrounding neighborhoods and to the lives of Ottawa's citizens?





ISSUES

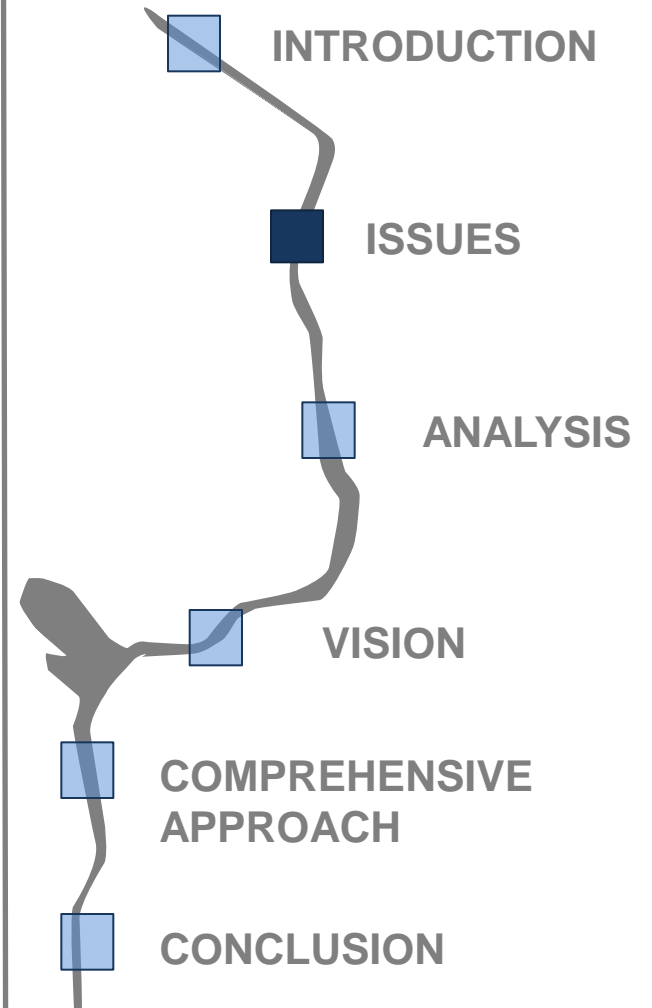







Photo: Apt613.ca







Carling Ave.
→ 400

Little Italy



SHINE
MUSIC
LESSONS
shinemusicgroup.com
913.881.1482





POLICIES CONCERNING THE CANAL

MULTIJURISDICTIONAL STEWARDSHIP

INTERNATIONAL

UNESCO World Heritage Designation

NATIONAL

Canal Regulations
Historic Canal Regulations
Rideau Canal Management Plan
Rideau Canal World Heritage Site Plan
Parkways & Pathways
Horizon 2067: 50 Year Plan
Central Experimental Farm National Historic Site Management Plan
National Historic Sites

PROVINCIAL

Provincial Policy Statement

MUNICIPAL

Growth Management Plans
Secondary Plans
Community Design Plans
Master Plans
Zoning By-law

3.0 – Criteria for Inscription on the World Heritage List

Criterion (i): The Rideau Canal is a masterpiece of human creative genius.

Criterion (ii): The Rideau Canal exhibits an important interchange of human values, over a span of time or within a cultural area of the world, on developments in technology.

Criterion (iv): The Rideau Canal is an outstanding example of a technological ensemble which illustrates a significant stage in human history.

Criteria (i) and (iv) are affirmed in ICOMOS evaluation documents.

WHAT IS ESSENTIAL?

From Parks Canada:

**RIDEAU CANAL WORLD
HERITAGE SITE
MANAGEMENT PLAN**

**Necessary to critically
evaluate what it means for
the Canal to be *authentic*.**

Early 1900s



Photo: Library and Archives Canada.

LAKE CANOE CLUB, OTTAWA

1906

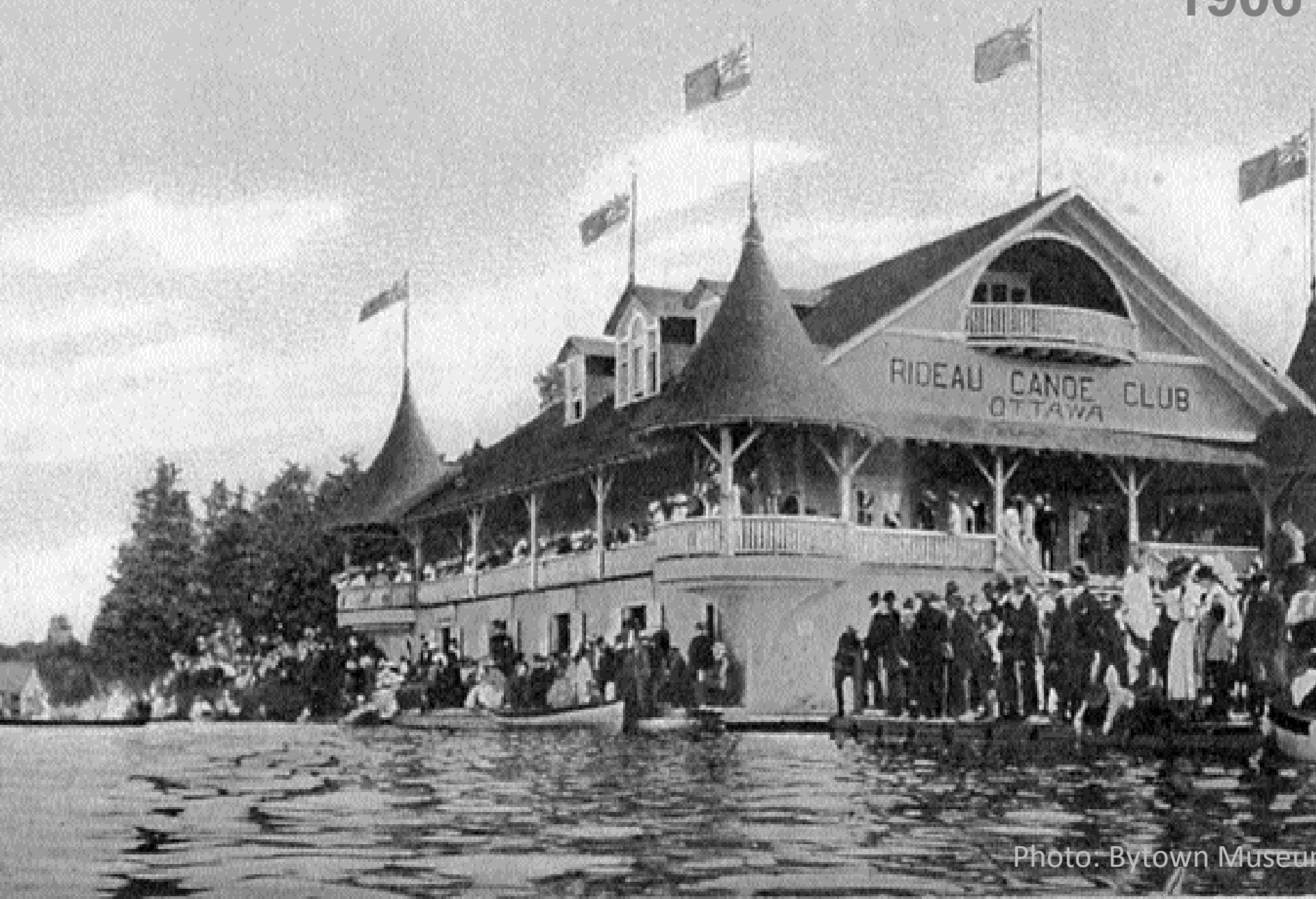

Photo: Bytown Museum

LIVING HERITAGE

From UNESCO:
**CONVENTION CONCERNING
THE PROTECTION OF THE
WORLD CULTURAL AND
NATURAL HERITAGE**

**Rideau Canal as companion
and soulmate of Ottawa.**

Article 5

1. to adopt a general policy which aims to give the cultural and natural heritage a **function in the life of the community** and to integrate the protection of that heritage into comprehensive planning programmes;



THE CANAL IN OTTAWA

On its path through central Ottawa, the Rideau Canal passes through several different urban conditions.

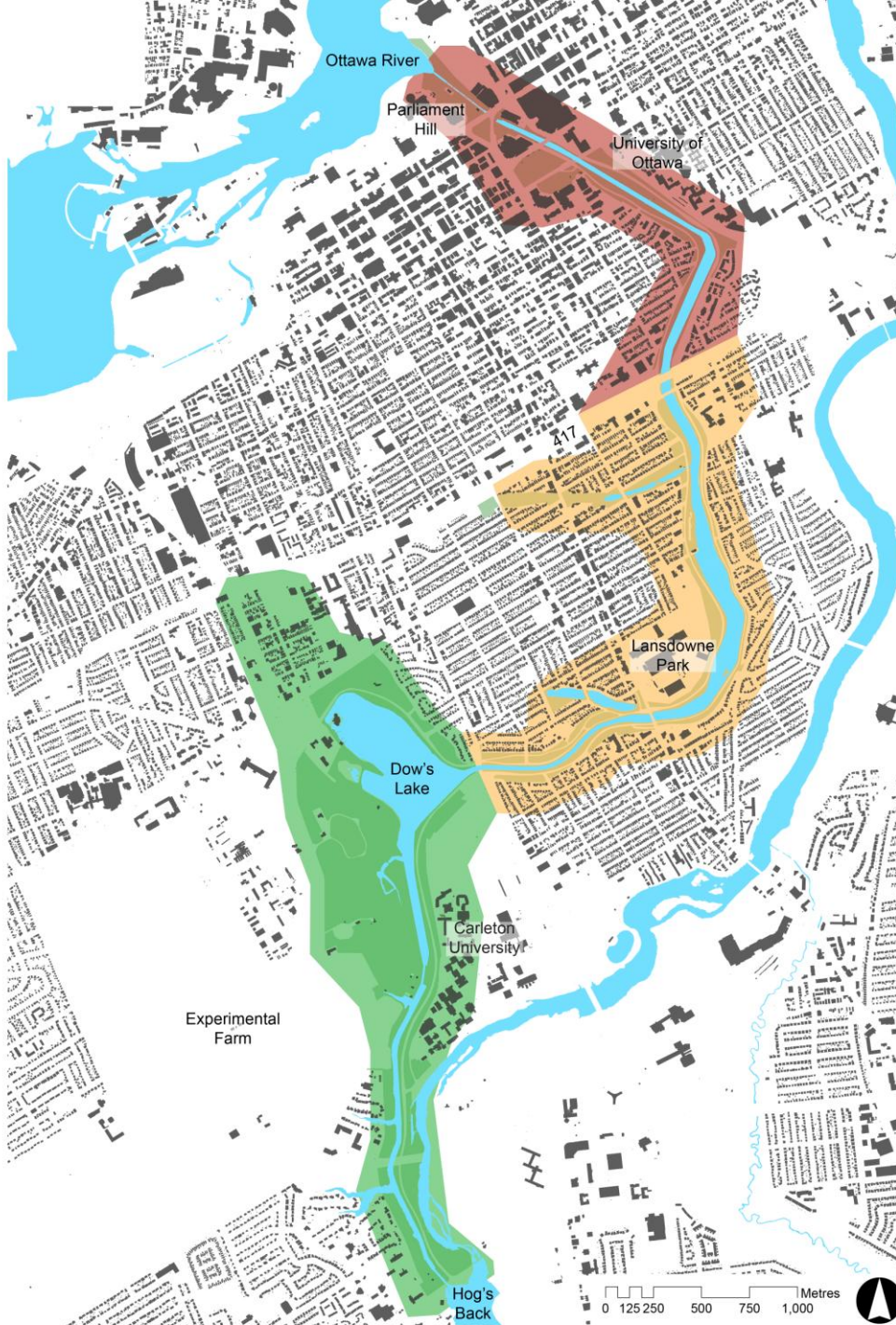

THE CANAL IN OTTAWA

On its path through central Ottawa, the Rideau Canal passes through several different urban conditions.





Golden Triangle

Old Ottawa East

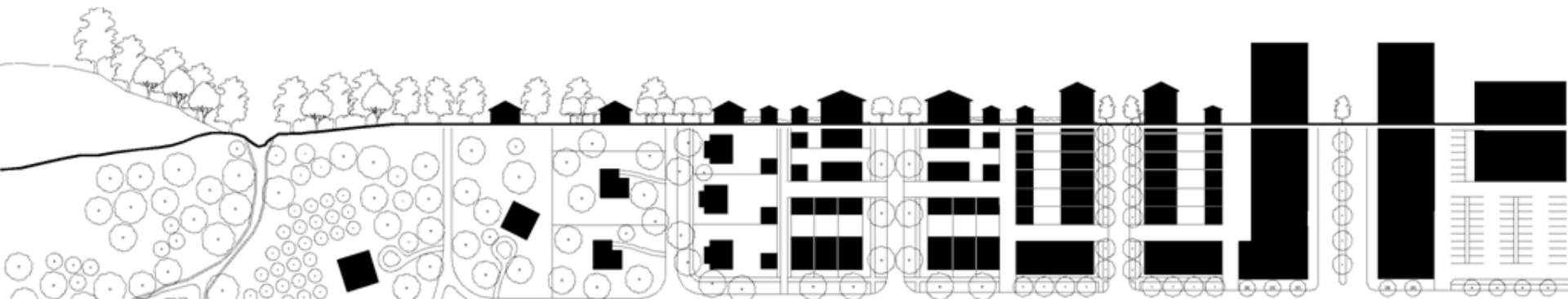
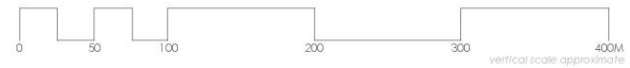



Glebe

Old Ottawa East

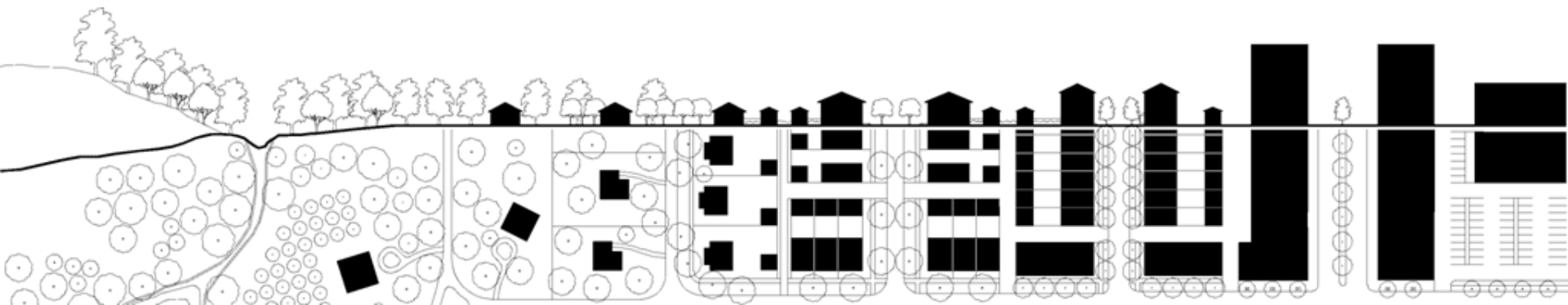
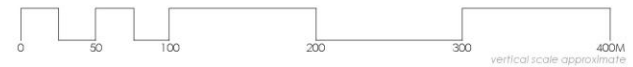



Little Italy

HMCS Carleton

Arboretum

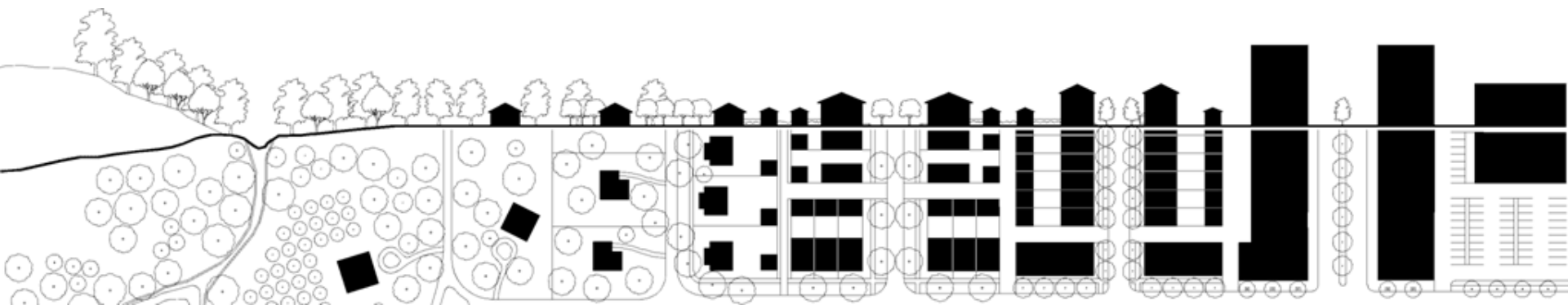

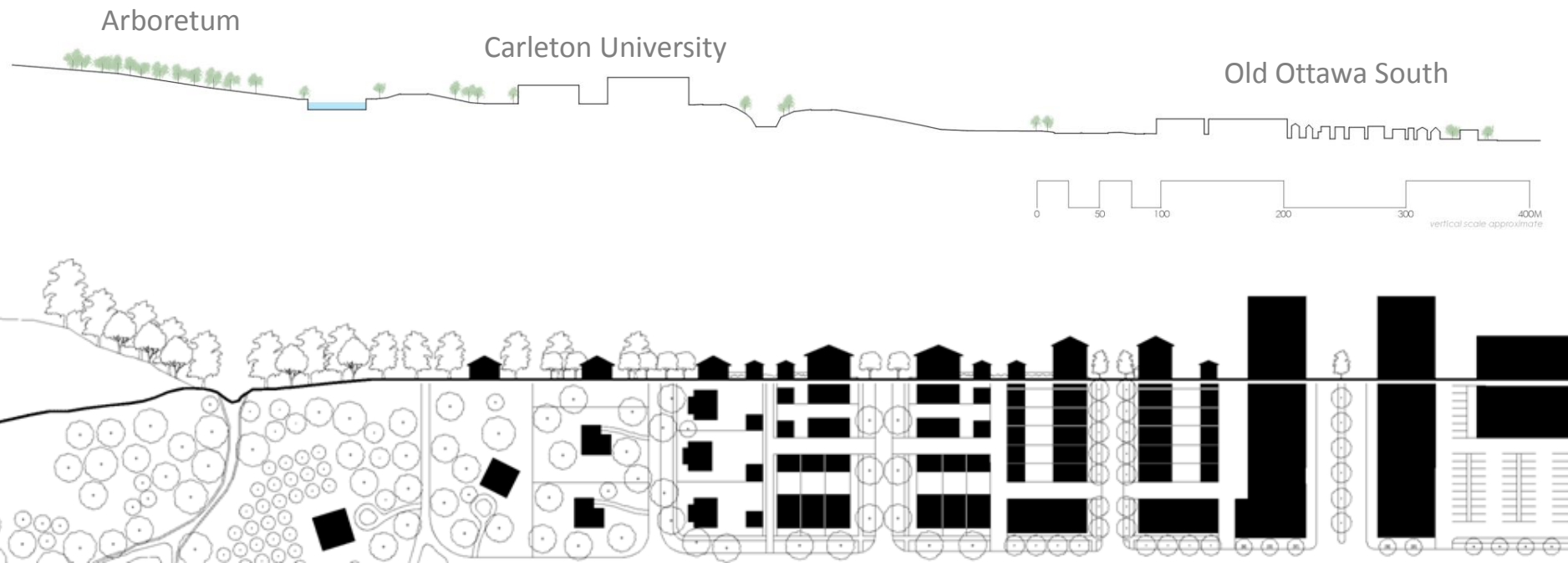





ANALYSIS

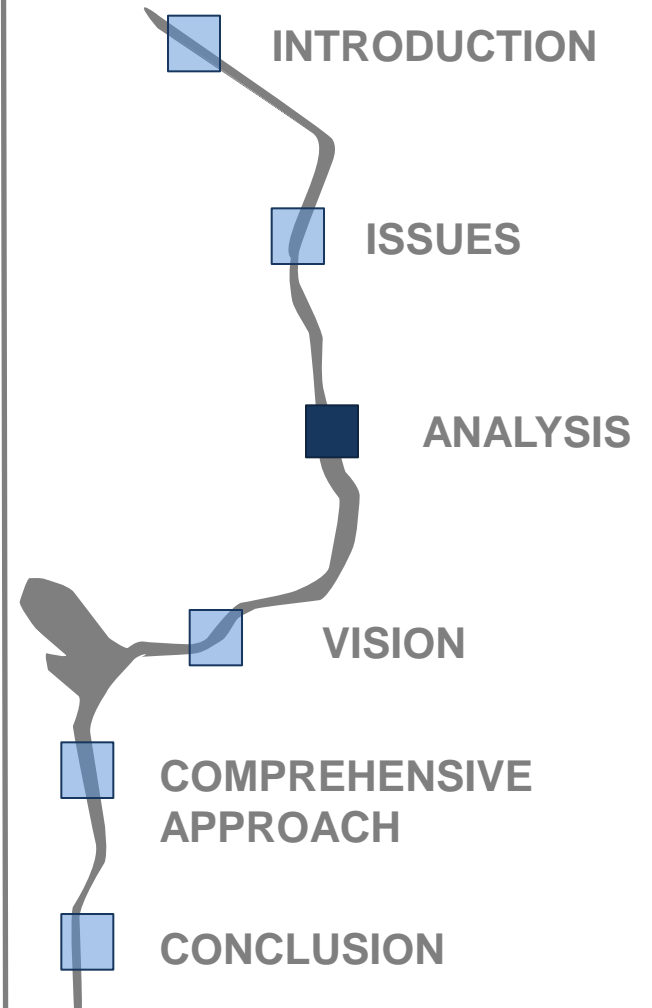

ANALYSIS

**Existing
Conditions**

**Compare with
Precedents**

Provide Direction



Source: www.asla.org

FULL LIST OF PRECEDENTS

Established Waterways

Large-Scale



Site-Specific

Chesapeake and Ohio Canal
Maryland & Washington D.C

Chicago Riverwalk
Chicago, IL

Ohio Canal Towpath
Cleveland, OH

H2O Park
Toronto, ON

Lechmere Canal Park
Cambridge, MA

City Centre Waterfront Program
Fort McMurray, AB

Ljubljana Banks & Bridges
Ljubljana, Slovenia

Folly for a Flyover
London, England

Liverpool Maritime Mercantile City
Liverpool, England

Onondaga Creekwalk
Syracuse, NY

RiverWalk
Calgary, AB

Paris Plages
Paris, France

River Walk
San Antonio, TX

Canal Regeneration Project
Glasgow, Scotland

Rochdale Canal
Manchester, England

City of Architecture@night
Rotterdam, Netherlands

Venice Beach Historic District
Los Angeles, CA

The High Line
New York City, NY

Badeshiff Spreebrücke
Berlin, Germany

The Trail River
Winnipeg, MB

Zayandeh River
Isfahan, Iran

Lachine Canal
Montréal, PQ

Clock Tower Beach
Montréal, PQ

Tussen-ruimte
Amsterdam, Netherlands

Canalside
Buffalo, NY

Liffey Boardwalk
Dublin, Ireland

Havnebadet
Copenhagen, Denmark

WaterFire
Providence, RI

FULL LIST OF PRECEDENTS

Established Waterways

Large-Scale



Site-Specific

Chesapeake and Ohio Canal
Maryland & Washington D.C

Chicago Riverwalk
Chicago, IL

Ohio Canal Towpath
Cleveland, OH

H2O Park
Toronto, ON

Lechmere Canal Park
Cambridge, MA

City Centre Waterfront Program
Fort McMurray, AB

Ljubljana Banks & Bridges
Ljubljana, Slovenia

Folly for a Flyover
London, England

Liverpool Maritime Mercantile City
Liverpool, England

Onondaga Creekwalk
Syracuse, NY

RiverWalk
Calgary, AB

Paris Plages
Paris, France

River Walk
San Antonio, TX

Canal Regeneration Project
Glasgow, Scotland

Rochdale Canal
Manchester, England

City of Architecture@night
Rotterdam, Netherlands

Venice Beach Historic District
Los Angeles, CA

The High Line
New York City, NY

Badeshiff Spreebrücke
Berlin, Germany

The Trail River
Winnipeg, MB

Zayandeh River
Isfahan, Iran

Lachine Canal
Montréal, PQ

Clock Tower Beach
Montréal, PQ

Tussen-ruimte
Amsterdam, Netherlands

Canalside
Buffalo, NY

Liffey Boardwalk
Dublin, Ireland

Havnebadet
Copenhagen, Denmark

WaterFire
Providence, RI

LESSONS FROM PRECEDENTS



- ✓ Mix of uses to attract diverse users at different times
- ✓ Supports year round activities
- ✓ Creative amenities that increase comfort and enjoyment

USE

- ✓ Surrounding buildings enhance public space
- ✓ A diversity of public spaces recurring along the waterfront
- ✓ Continuous waterfront system connected both visually and physically
- ✓ Well linked to surrounding neighbourhood with few barriers
- ✓ Accessible by wide range of transportation types
- ✓ Iconic buildings serve a variety of functions and are reflect the human scale

PHYSICAL ATTRIBUTES

- ✓ Creates a unique sense of place and identity
- ✓ Recognizes and celebrates cultural heritage
- ✓ Takes advantage of waterway and corridor

CHARACTER



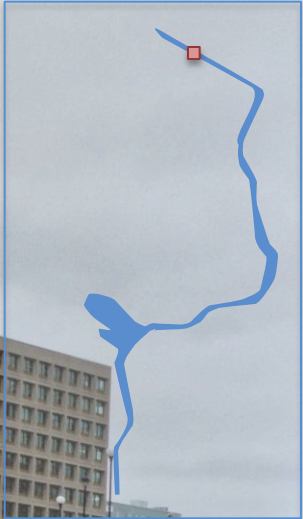

RIVER WALK

SAN ANTONIO RIVER
SAN ANTONIO, TEXAS







THE REVAMP OF THE LJUBLJANICA BANKS & BRIDGES

LJUBLJANICA RIVER

LJUBLIJANA, SLOVENIA (NATIONAL CAPITAL)







RIVERWALK

BOW RIVER
CALGARY, ALBERTA



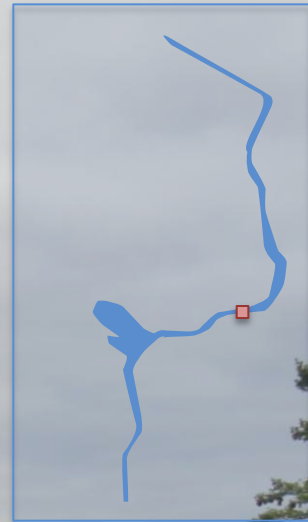



BADESCHIFF

SPREE RIVER

BERLIN, GERMANY (NATIONAL CAPITAL)



BADESCHIFF

SPREE RIVER

BERLIN, GERMANY (NATIONAL CAPITAL)



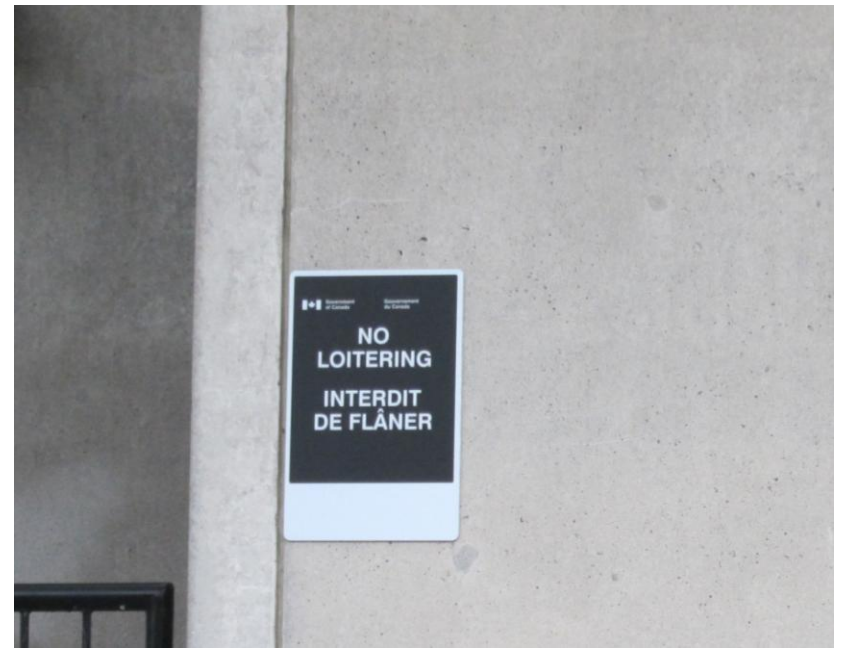

Source: www.mainstreeter.ca

GLASGOW CANAL REGENERATION PROJECT

FORTH & CLYDE CANAL GLASGOW, SCOTLAND



GLASGOW CANAL REGENERATION PROJECT

FORTH & CLYDE CANAL GLASGOW, SCOTLAND







FOLLY FOR A FLYOVER

LEA NAVIGATION CANAL

LONDON, ENGLAND (NATIONAL CAPITAL)



DESIGN CHARRETTE

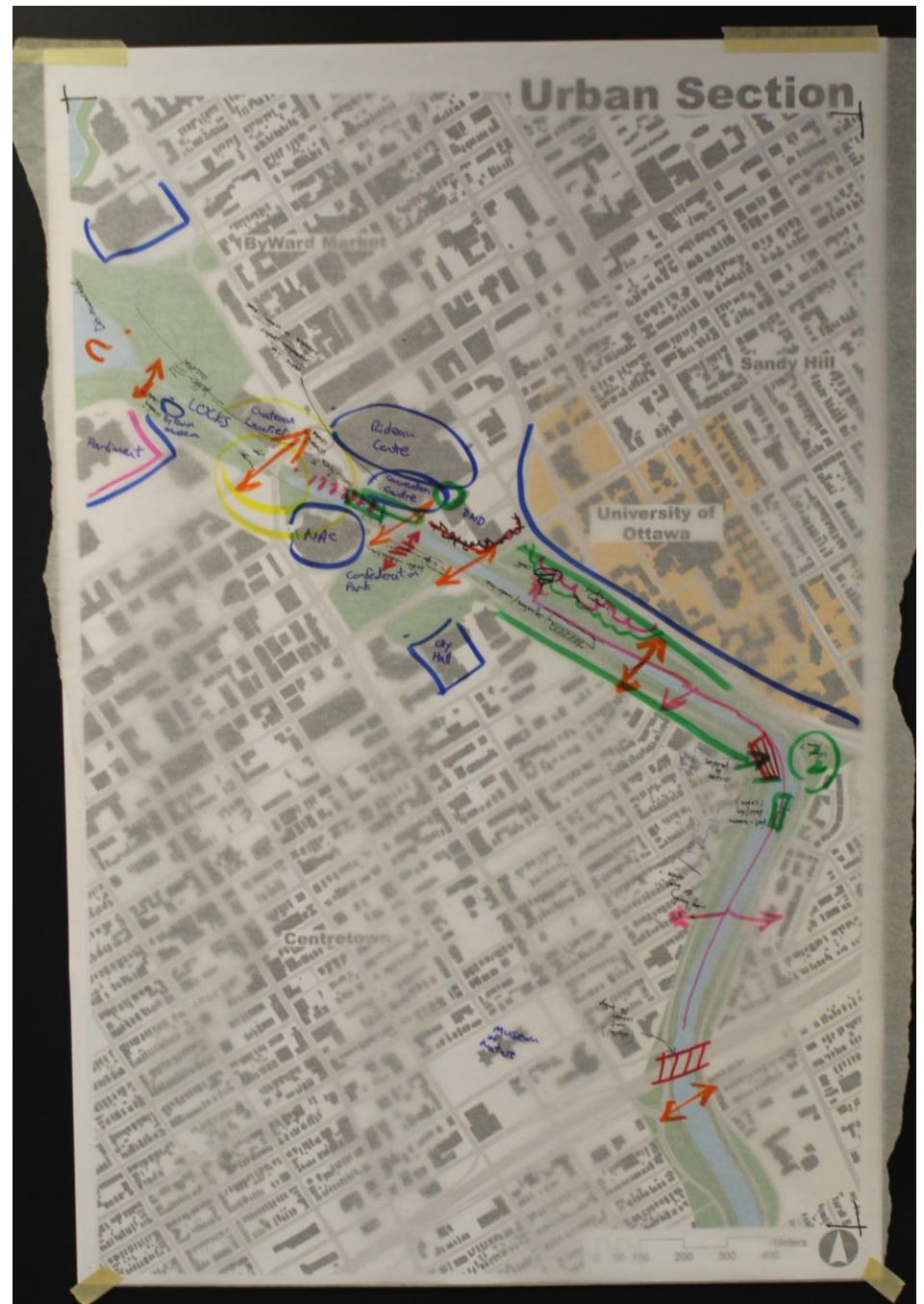

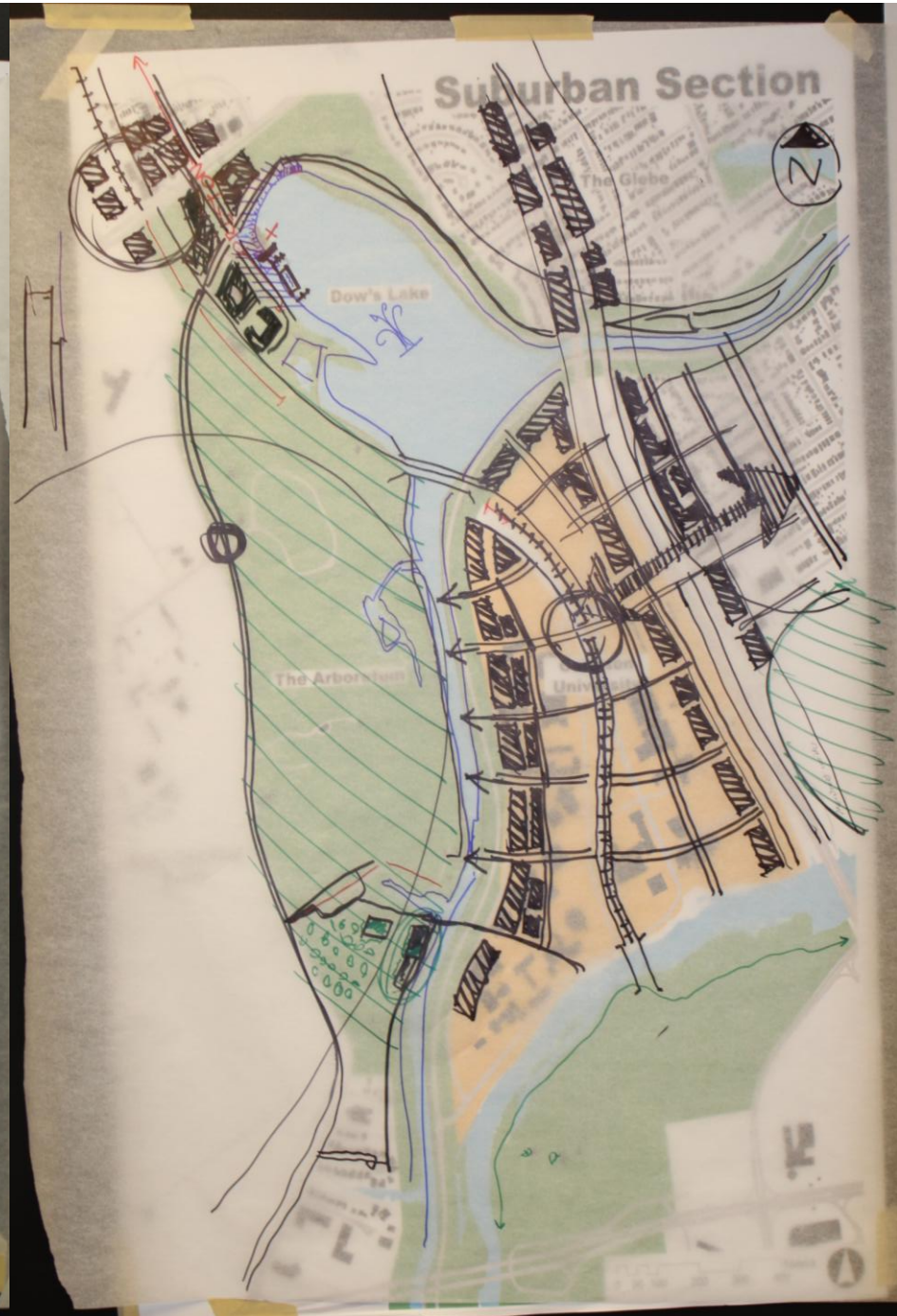
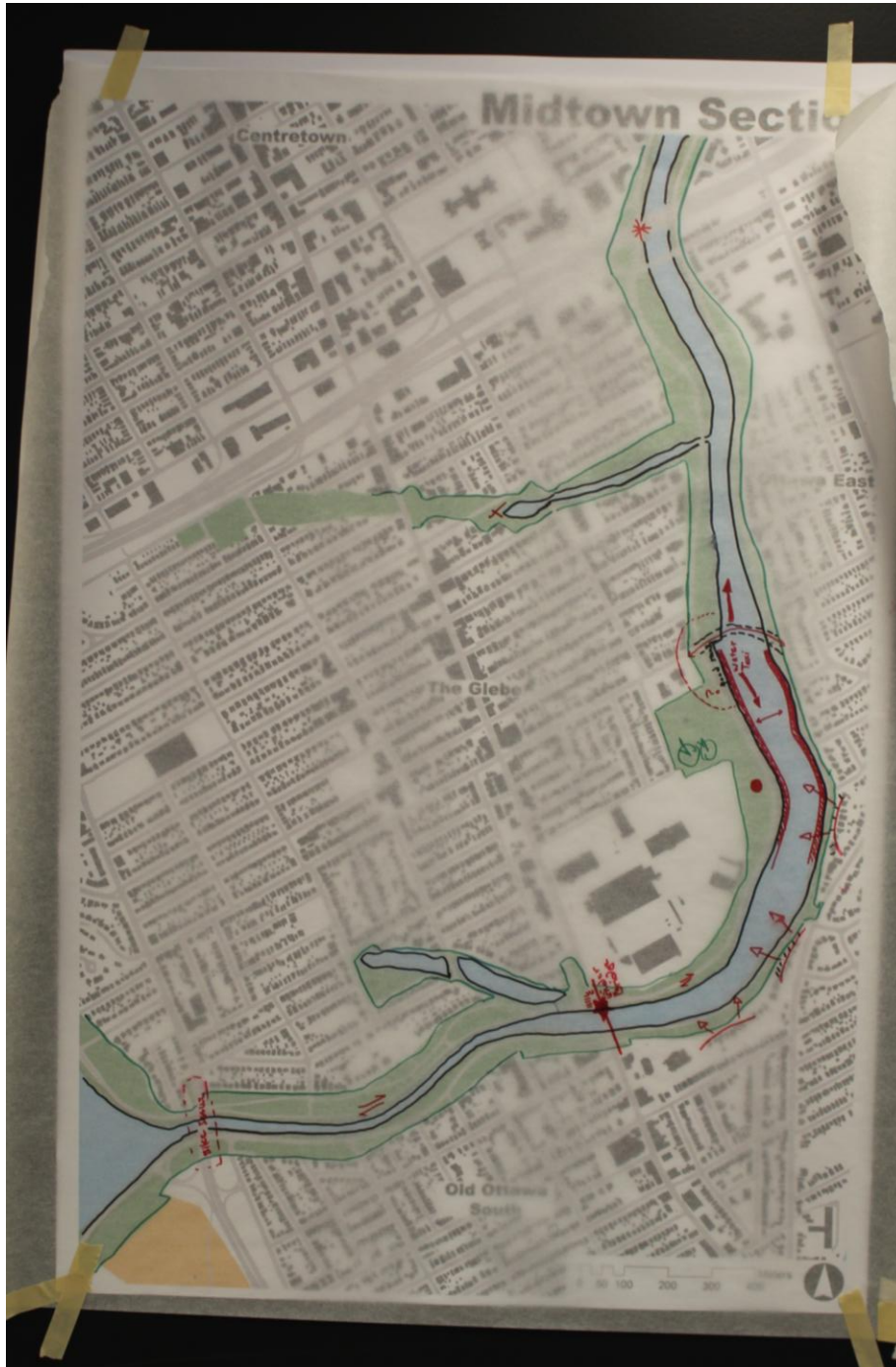

Canal Corridor

1) CANAL AS A BARRIER

2) COMPLETE STREETS

- ACCOMMODATE ALL MODES
 - ↳ OVERHANGS (canals)
 - ↳ BIKI BIKES
 - ↳ SAFETY ISSUES

3) BRIDGES AS PATIOS

- new at least

⑤ Bow's Rec. Loop

4) PARKING

- better utilize existing

⑤ Heritage Bldg along corridor

5) POTENTIAL TRAFFIC BOTTLENECKS

- in downtown

6) STREET FURNITURE

7) ILLUMINATION - bridges

8) PEDESTRIAN AMENITIES

- walkway
- signage to crossing

9) SIGNAGE / CROSSWALK MARKINGS

- corridor

10) LANDSCAPING

11) ACCESSIBILITY

CANAL CROSSINGS



WHERE NEXT?



Vision

Goals

Policy
Objectives

Policies

Strategies



VISION

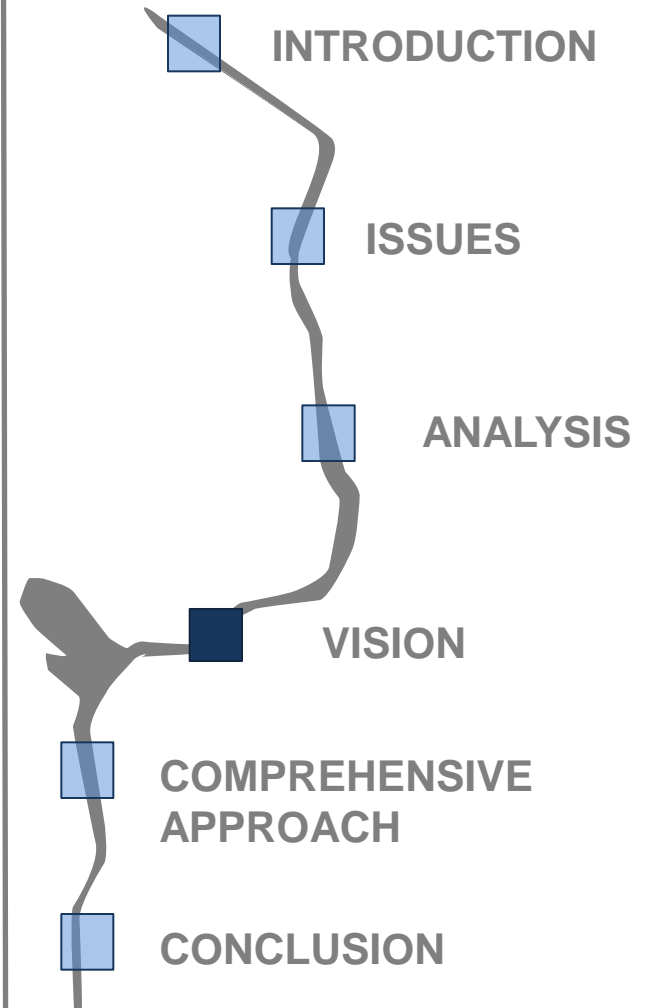

VISION

The background image is a composite of two night-time photographs of Ottawa. The top half shows a modern building with a glass facade and a grid-like structure, illuminated from within, set against a dark blue sky with wispy clouds. The bottom half shows a canal scene with several boats docked at a stone pier. The water is dark, and the boats are lit up. The overall tone is urban and sophisticated.

The Rideau Canal should be a vibrant and integral feature within the City of Ottawa that contributes to making connections and balancing past and future identities of the nation's capital.

VISION

IMPROVE CONNECTIVITY ACROSS THE CANAL

CONNECTIVITY

INTEGRATE

**JOURNEY &
DESTINATION**

HERITAGE

PARTNERSHIPS



Photo: Flickr, 2013

VISION

INTEGRATE THE CANAL WITH NEIGHBOURHOODS

CONNECTIVITY

INTEGRATE

**JOURNEY &
DESTINATION**

HERITAGE

PARTNERSHIPS



VISION

CREATE A JOURNEY AND DESTINATION

CONNECTIVITY

INTEGRATE

**JOURNEY &
DESTINATION**

HERITAGE

PARTNERSHIPS



Photo: Flickr, 2013

VISION

RESPECT THE CANAL'S CHARACTER & HERITAGE

CONNECTIVITY

INTEGRATE

**JOURNEY &
DESTINATION**

HERITAGE

PARTNERSHIPS



VISION

CREATE PARTNERSHIPS

CONNECTIVITY

INTEGRATE

JOURNEY & DESTINATION

HERITAGE

PARTNERSHIPS



Photo: Ottawa Citizen, 2007

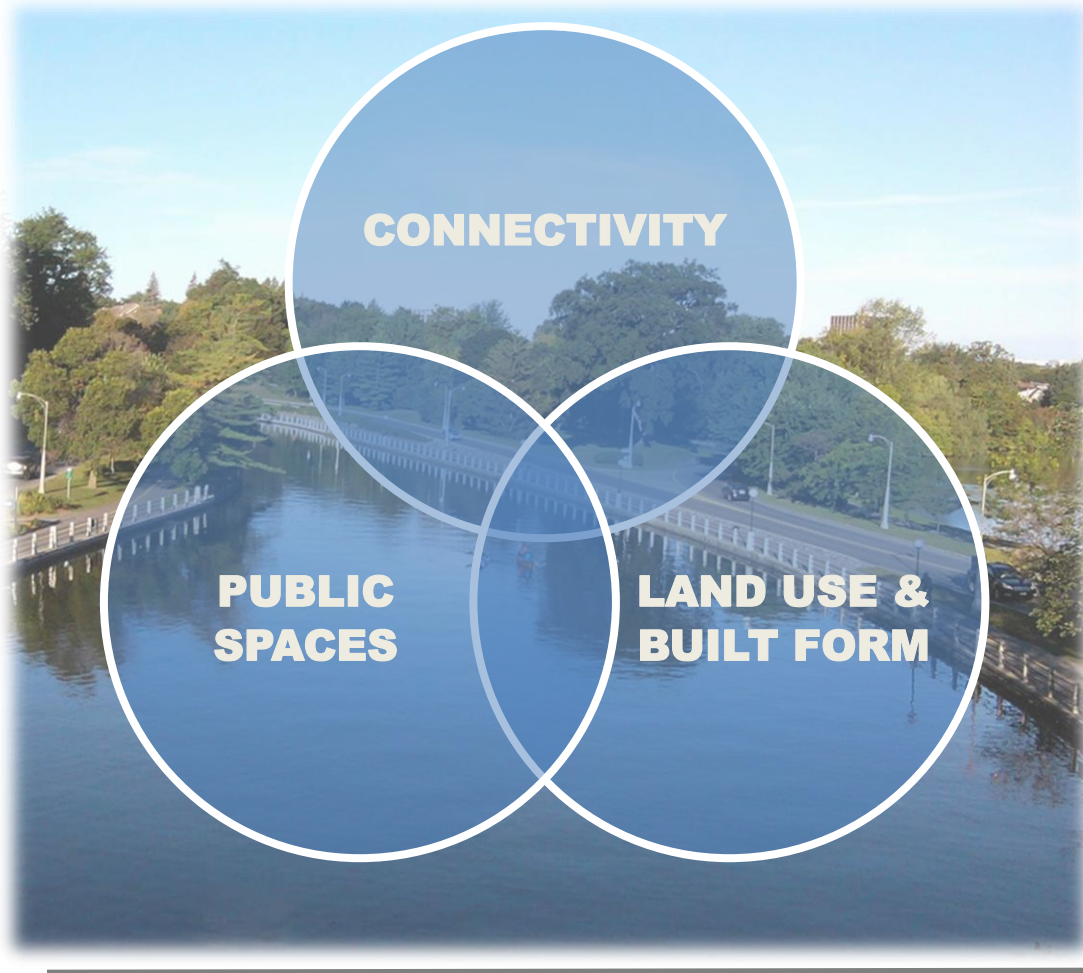

COMPREHENSIVE APPROACH

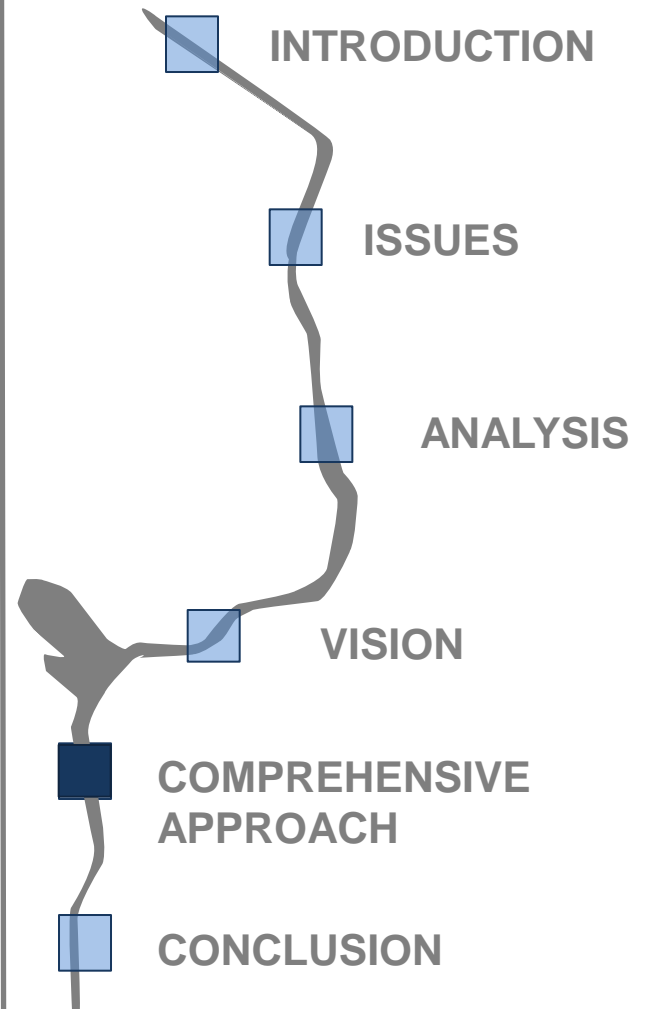

PUBLIC SPACE

DIVERSITY

**IDENTITY &
HERITAGE**

EDGES



PUBLIC SPACES

DIVERSITY

IDENTITY & HERITAGE

EDGES



PUBLIC SPACES

DIVERSITY

IDENTITY & HERITAGE

EDGES



**PUBLIC
SPACES**

**INCREASE THE DIVERSITY
OF PUBLIC SPACES**

DIVERSITY

**IDENTITY &
HERITAGE**

EDGES



**PUBLIC
SPACES**

**INCREASE THE DIVERSITY
OF PUBLIC SPACES**

DIVERSITY

**IDENTITY &
HERITAGE**

EDGES



**PUBLIC
SPACES**

**INCREASE THE DIVERSITY
OF PUBLIC SPACES**



**PUBLIC
SPACES**

**INCREASE THE DIVERSITY
OF PUBLIC SPACES**



**PUBLIC
SPACES**

**CELEBRATE THE CANAL'S
HISTORIC CHARACTER**

DIVERSITY

**IDENTITY &
HERITAGE**

EDGES



**PUBLIC
SPACES**

**CELEBRATE THE CANAL'S
HISTORIC CHARACTER**

DIVERSITY

**IDENTITY &
HERITAGE**

EDGES

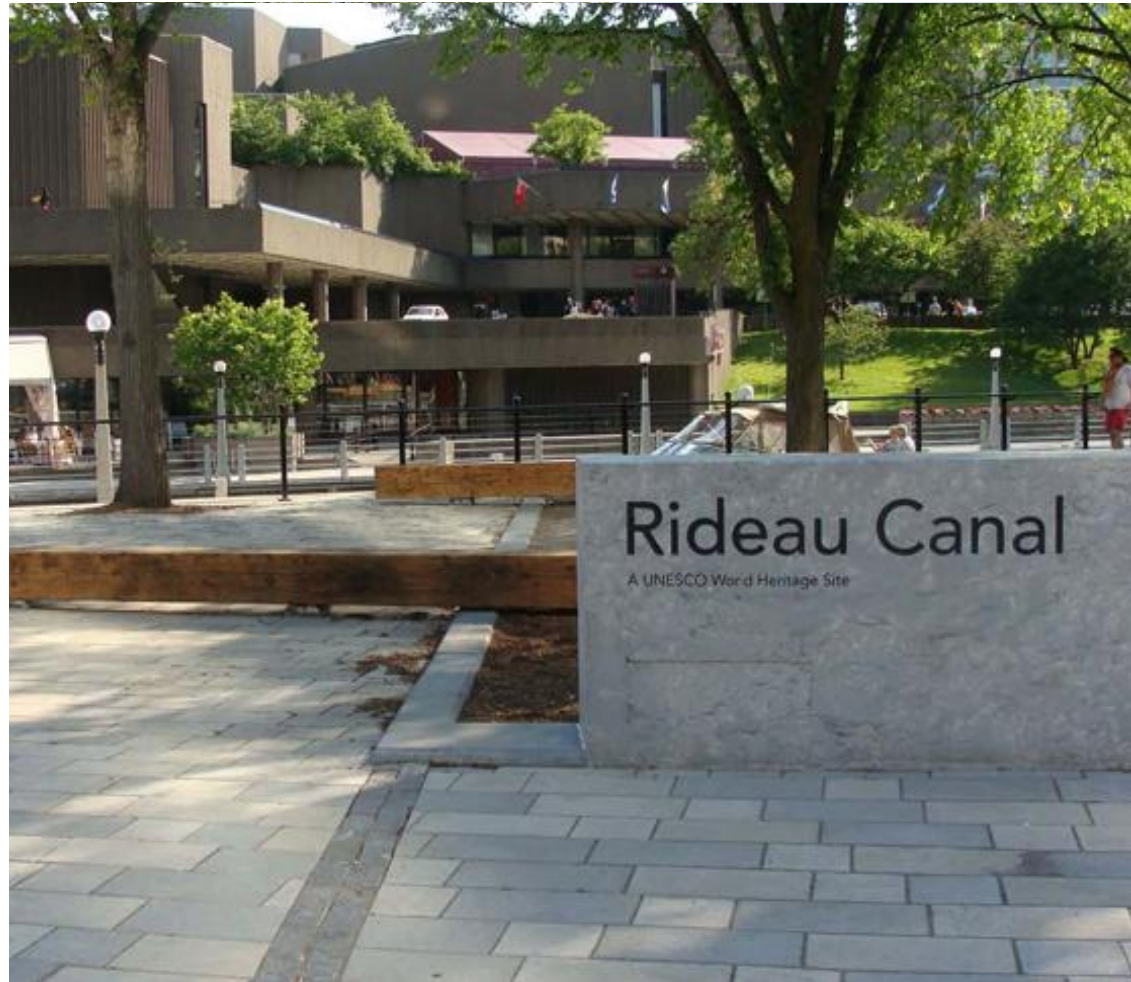

**PUBLIC
SPACES**

**ENHANCE EDGES & PROVIDE
CLEAR TRANSITIONS**



PUBLIC SPACES

ENHANCE EDGES & PROVIDE CLEAR TRANSITIONS



CONNECTIVITY

ACCESS

MOVEMENT

LINKAGES

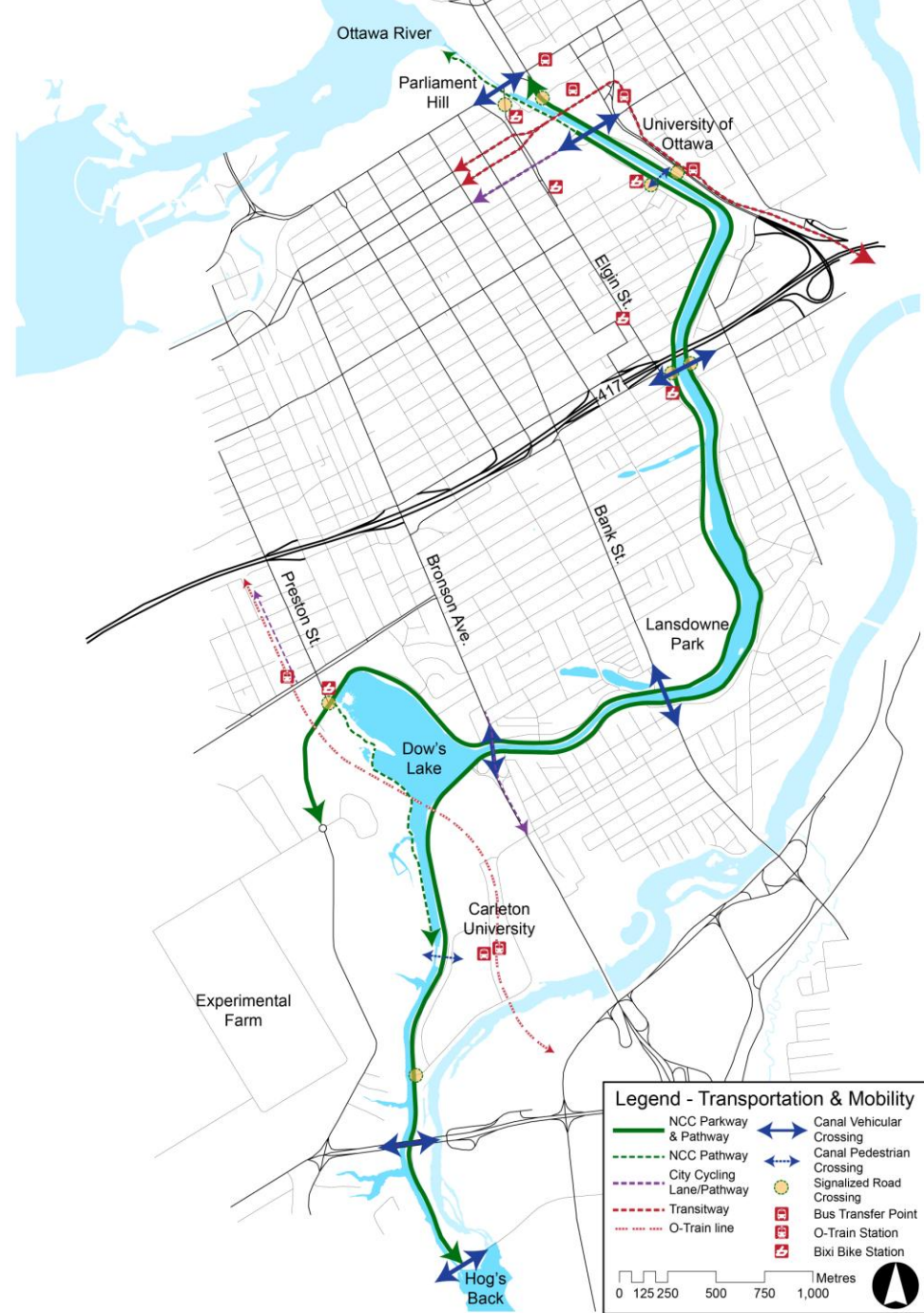

CONNECTIVITY

ACCESS

MOVEMENT

LINKAGES

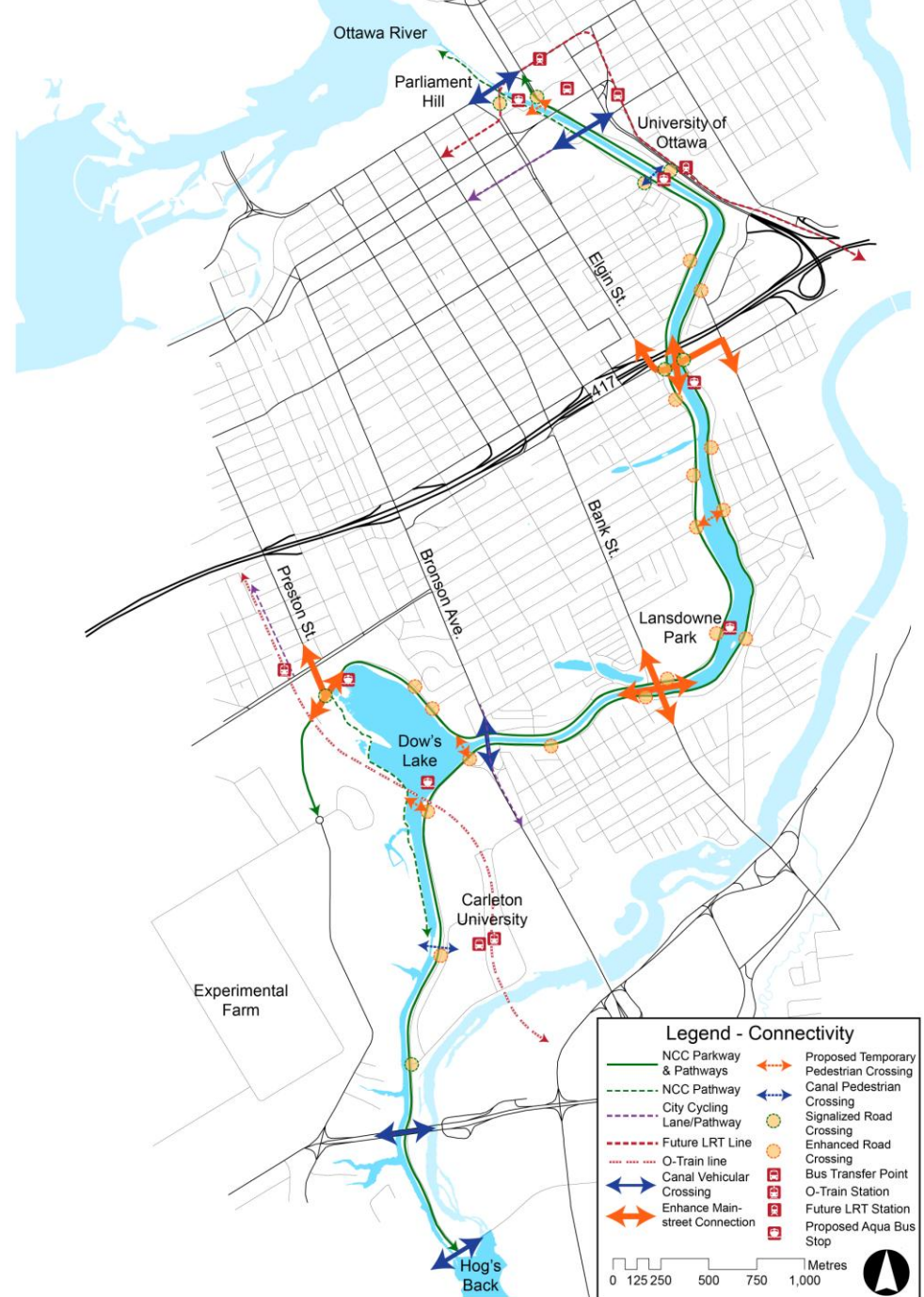

CONNECTIVITY

**ENHANCE ACCESS TO
THE WATERWAY**

ACCESS

MOVEMENT

LINKAGES



Photo: <http://torontosavvy.me> (2013).

CONNECTIVITY

ENHANCE ACCESS TO THE WATERWAY



Photo: Google (2013)

CONNECTIVITY

**ENHANCE ACCESS TO
THE WATERWAY**



CONNECTIVITY

**ENHANCE MOVEMENT
ALONG THE WATERWAY**

ACCESS

MOVEMENT

LINKAGES



Photo: <http://chugrenade.me/tag/bc-place/> (2013)).

CONNECTIVITY

ENHANCE MOVEMENT ACROSS THE WATERWAY



Photo: Google (2013)

CONNECTIVITY

**ENHANCE MOVEMENT
ACROSS THE WATERWAY**



CONNECTIVITY

**ENHANCE MOVEMENT
ACROSS THE WATERWAY**



CONNECTIVITY

**ENHANCE LINKAGES TO
NEIGHBOURHOODS**

ACCESS

MOVEMENT

LINKAGES



CONNECTIVITY

ENHANCE LINKAGES TO NEIGHBOURHOODS



Photo: Google (2013)

CONNECTIVITY

ENHANCE LINKAGES TO NEIGHBOURHOODS



LAND USE & BUILT FORM

LAND USE

DENSITY

**BUILDING
APPROACH**

**SPECIAL
AREAS**



(Canada)

Photo: Skyscraperpage.com (2013).

LAND USE & BUILT FORM

LAND USE

DENSITY

BUILDING APPROACH

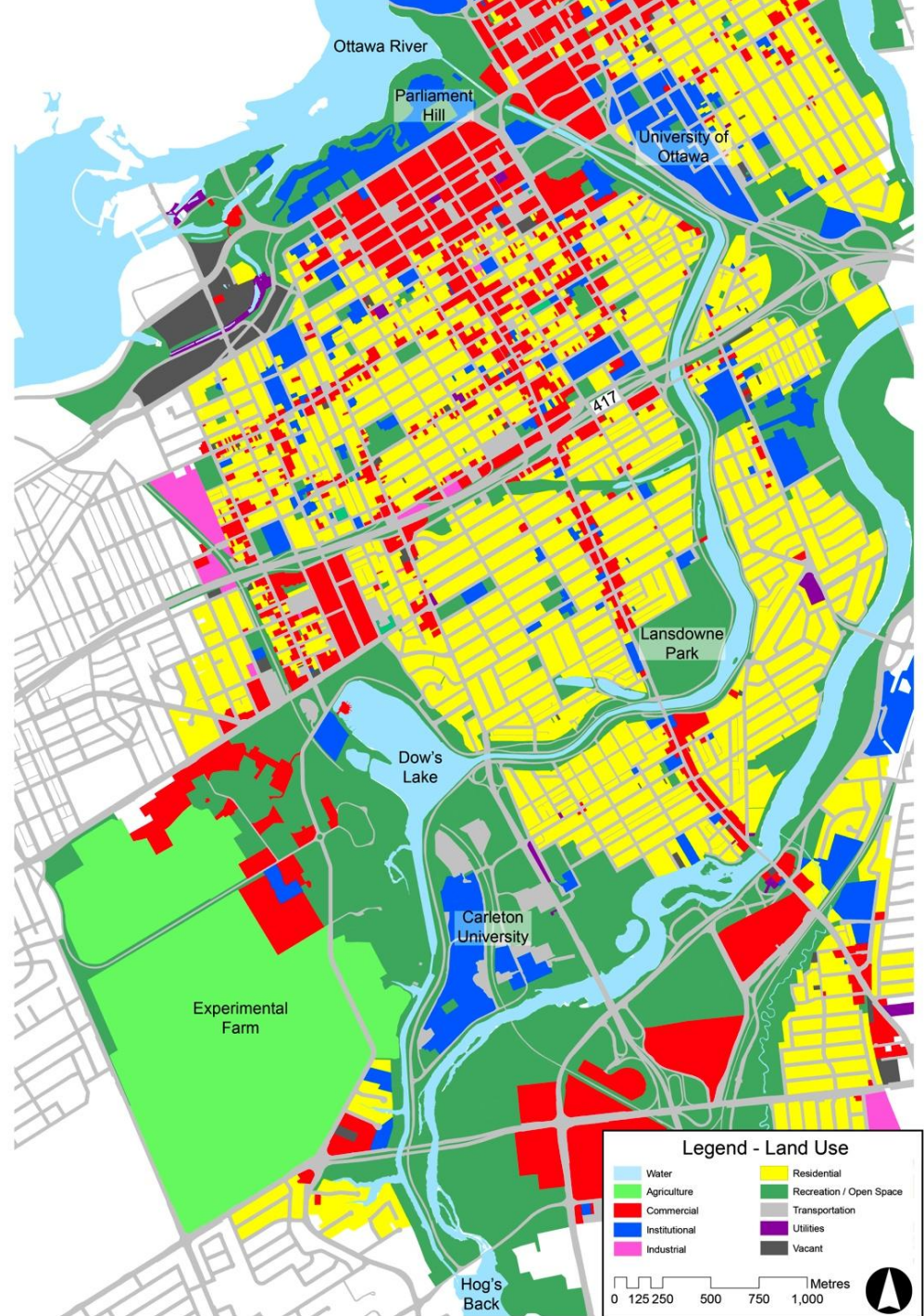

LAND USE & BUILT FORM

LAND USE

DENSITY

BUILDING APPROACH

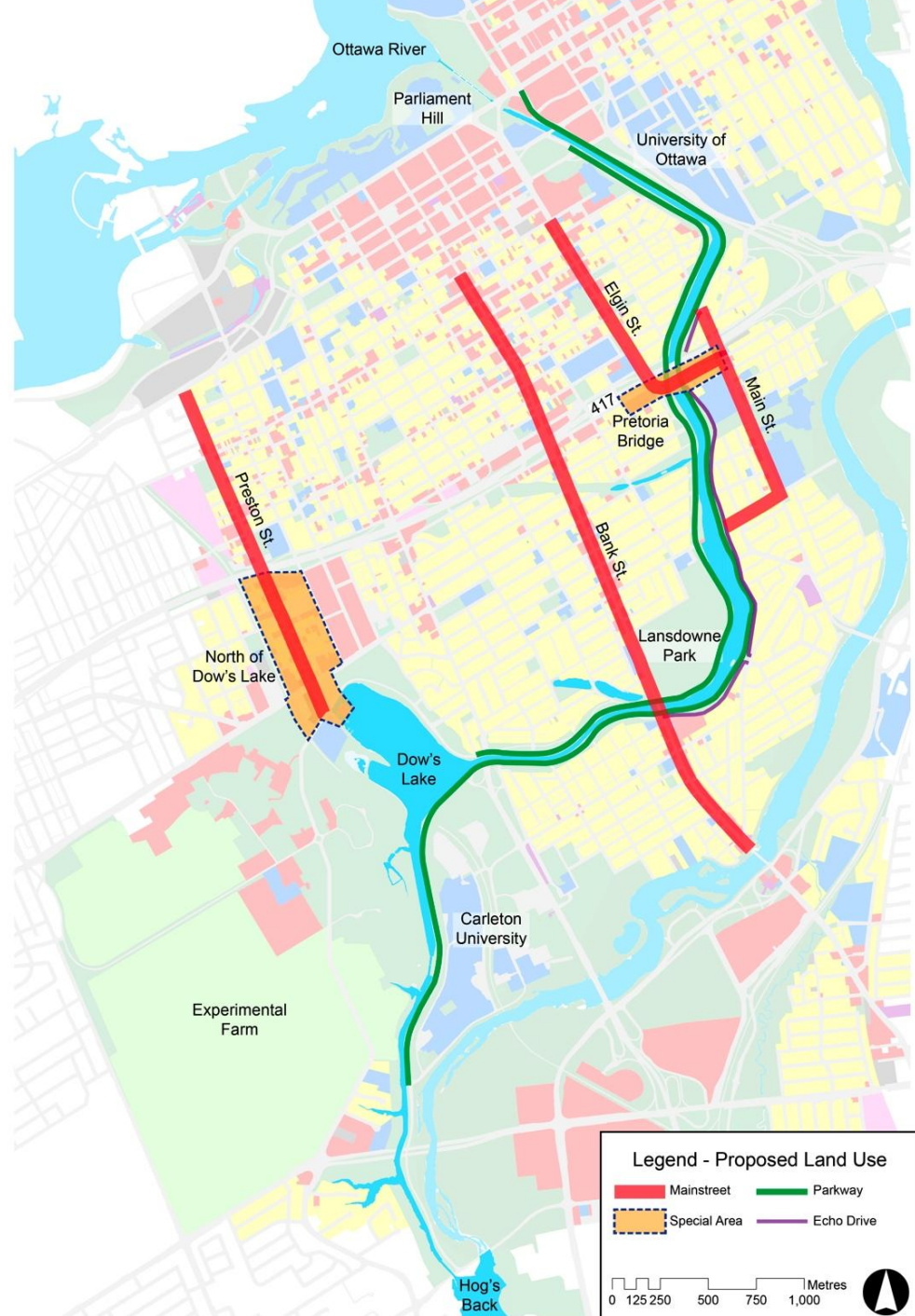

LAND USE & BUILT FORM

CONTEXT APPROPRIATE BUILT FORM

LAND USE

DENSITY

**BUILDING
APPROACH**



Photo: Clarridge

LAND USE & BUILT FORM

CONTEXT APPROPRIATE BUILT FORM

LAND USE

DENSITY

**BUILDING
APPROACH**



Photo: Dorothy's Closet

LAND USE & BUILT FORM

CONTEXT APPROPRIATE BUILT FORM

LAND USE

DENSITY

**BUILDING
APPROACH**



LAND USE & BUILT FORM

CONTEXT APPROPRIATE BUILT FORM

LAND USE

DENSITY

**BUILDING
APPROACH**

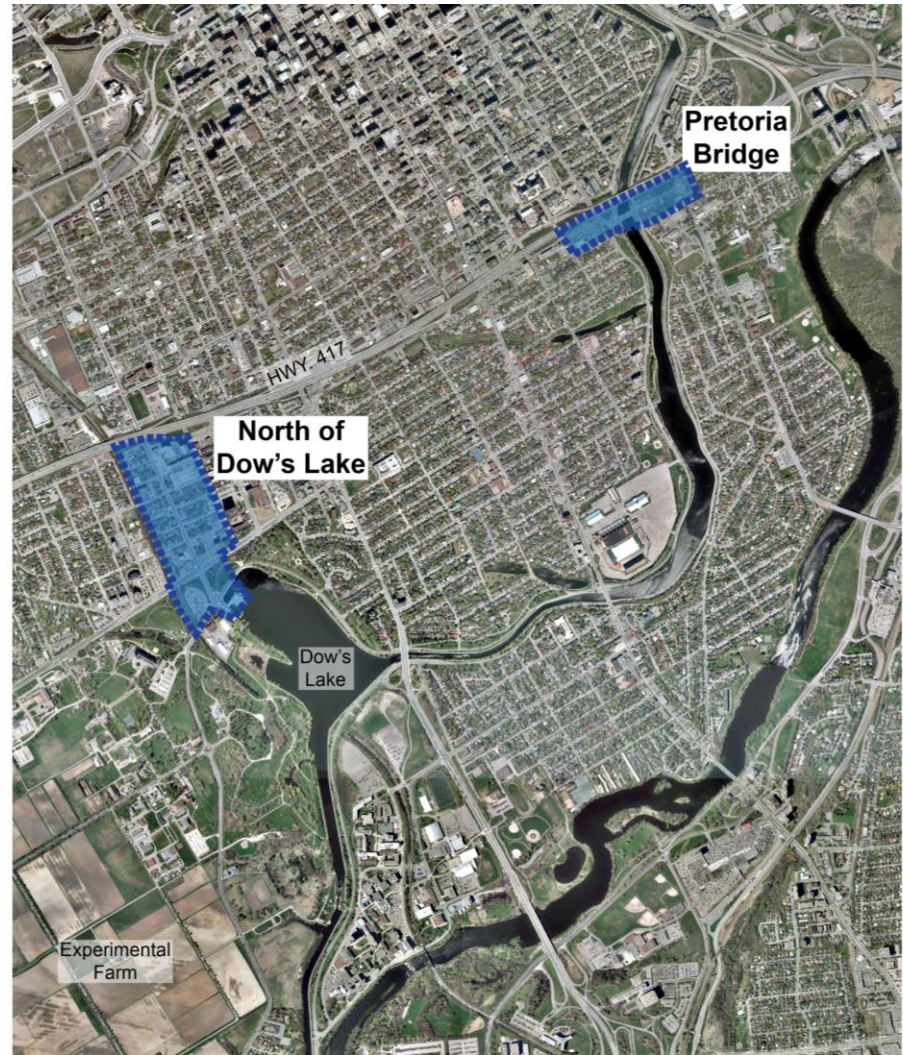

Photo: ReStart (2013).

Special Areas

**Pretoria
Bridge**

**Dow's Lake
North**



LAND USE & BUILT FORM

SPECIAL AREAS PRETORIA BRIDGE

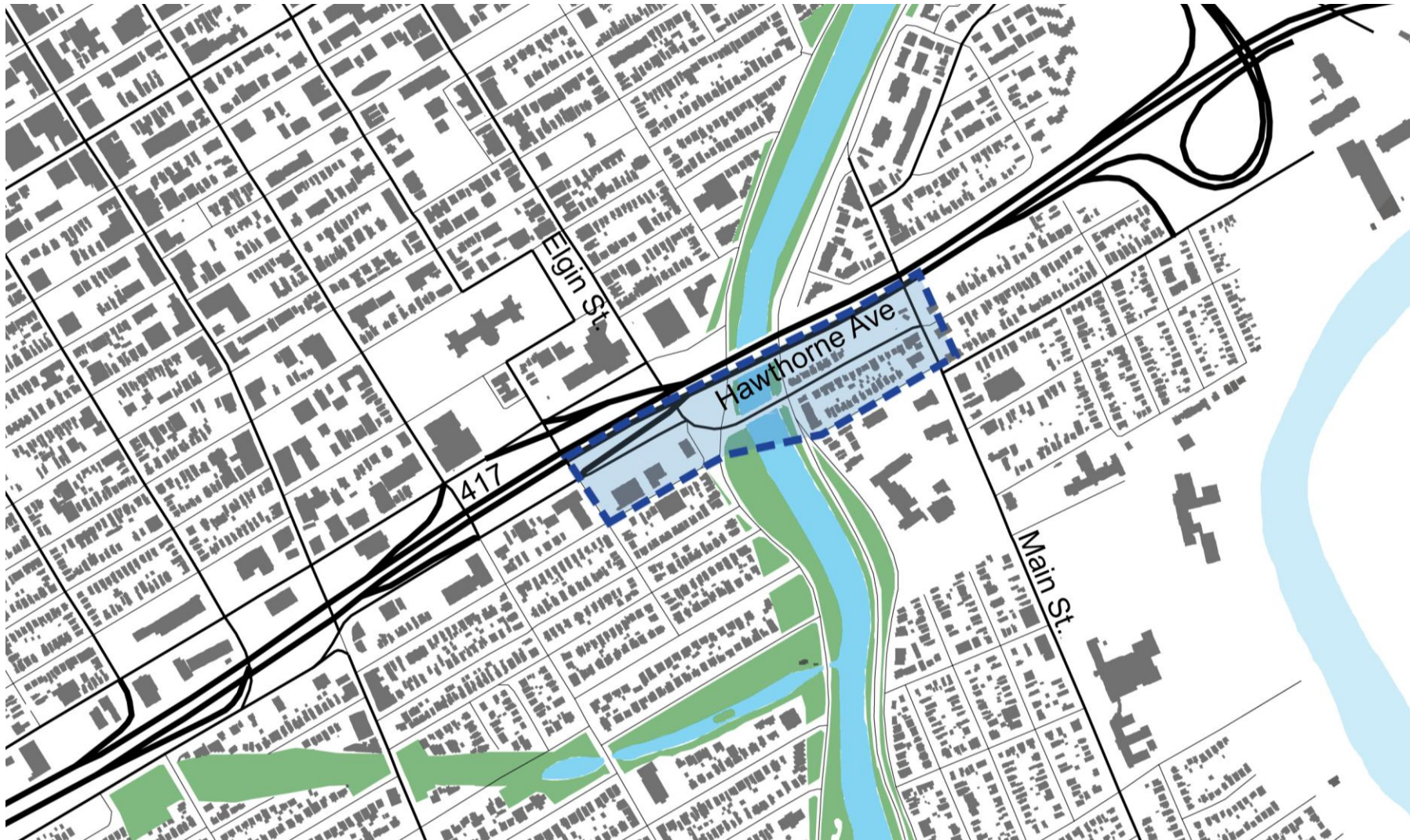

LAND USE & BUILT FORM

SPECIAL AREAS PRETORIA BRIDGE



LAND USE & BUILT FORM

SPECIAL AREAS PRETORIA BRIDGE

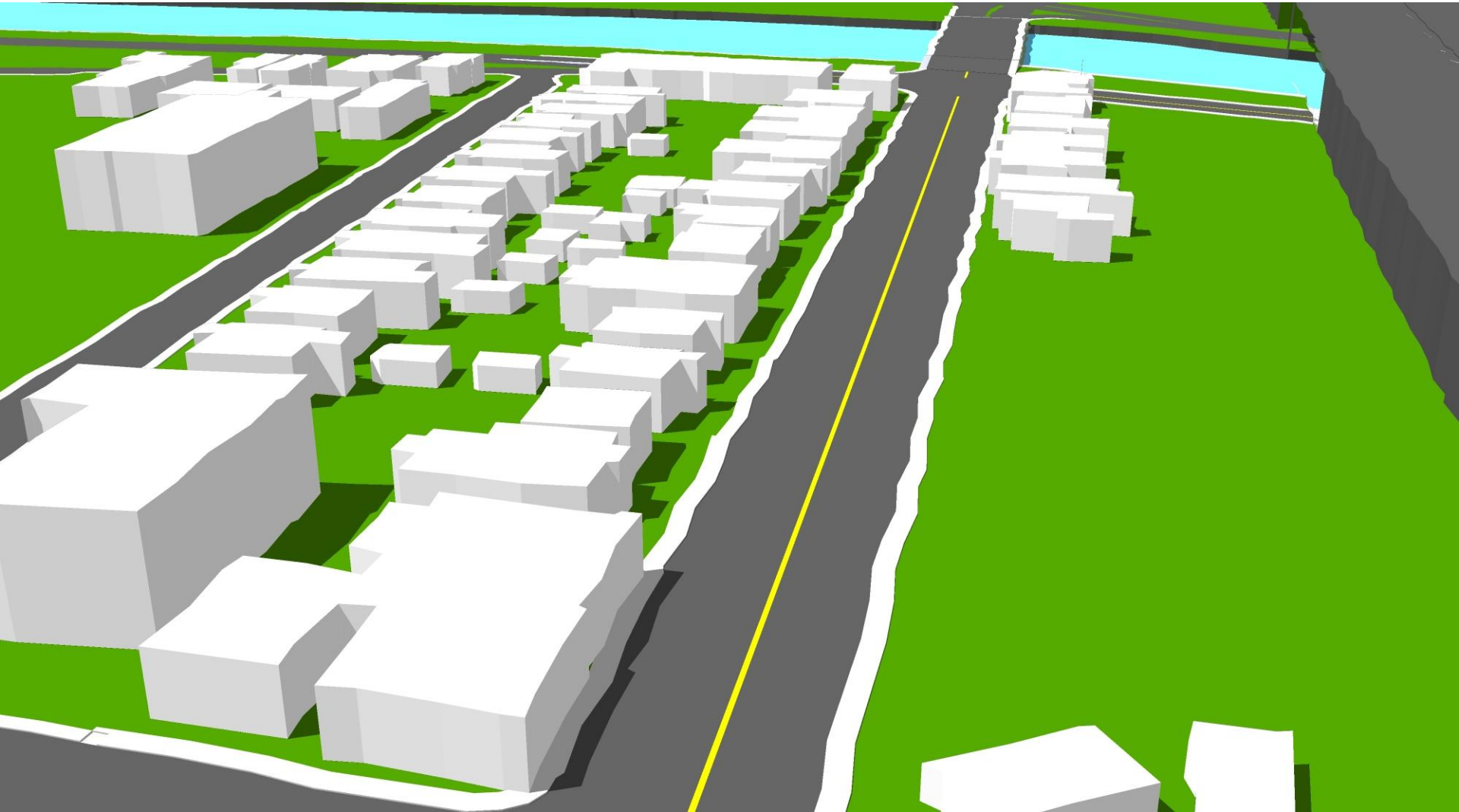

LAND USE & BUILT FORM

SPECIAL AREAS PRETORIA BRIDGE

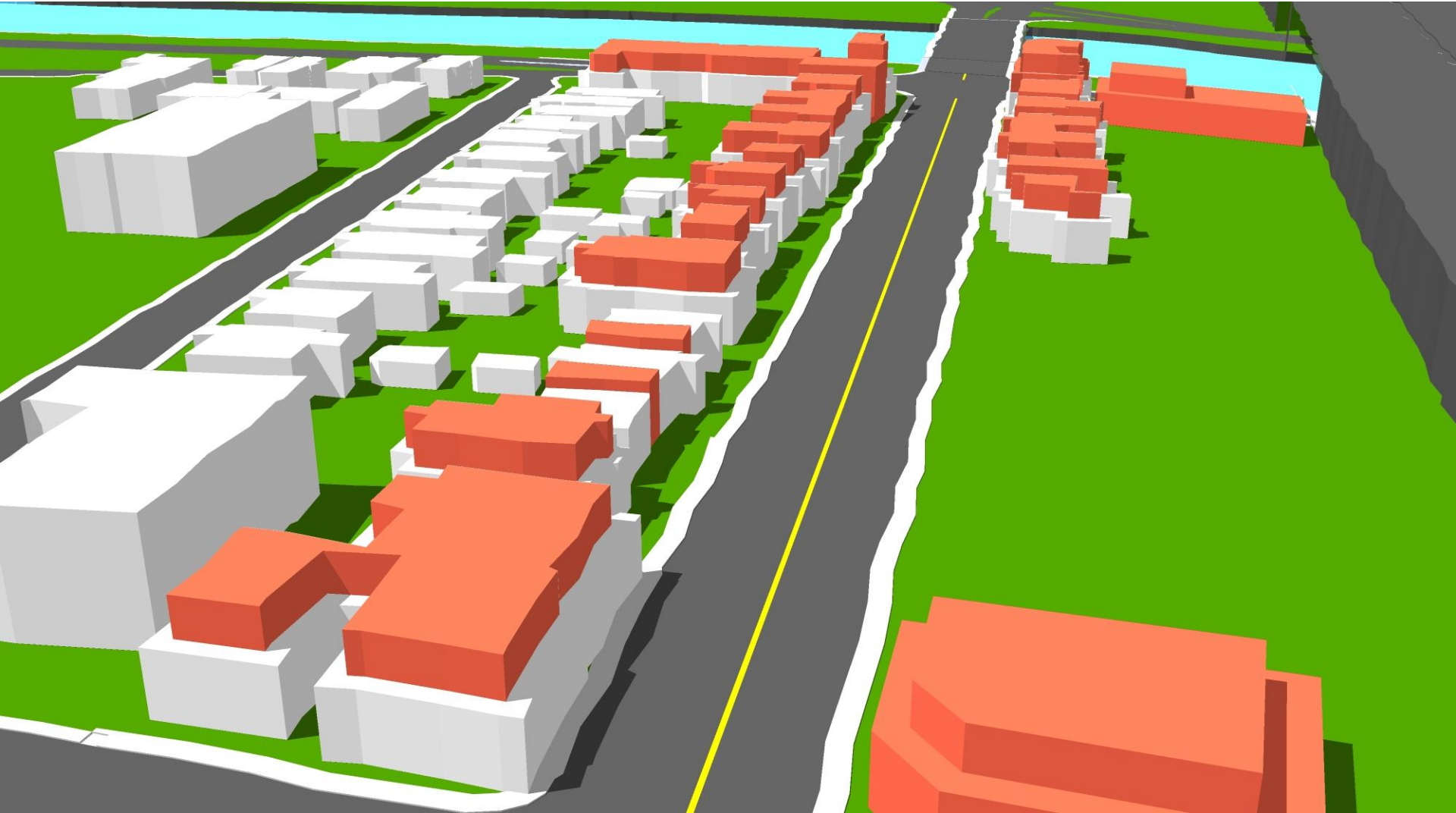

LAND USE & BUILT FORM

SPECIAL AREAS NORTH OF DOW'S LAKE



LAND USE & BUILT FORM

SPECIAL AREAS NORTH OF DOW' S LAKE



Photo: Little Italy BIA

LAND USE & BUILT FORM

NORTH OF DOW'S LAKE PRESENT

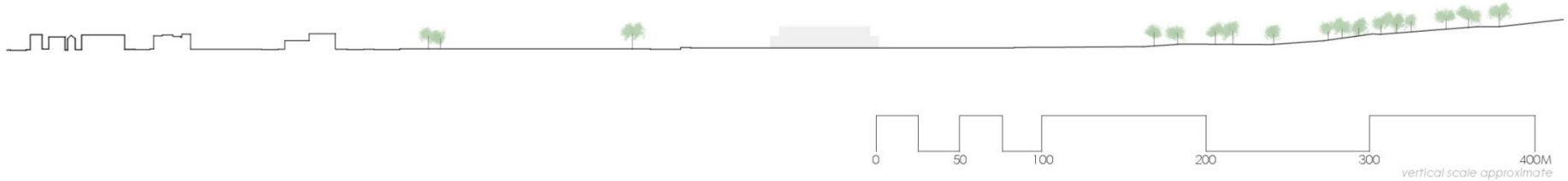

LAND USE & BUILT FORM

NORTH OF DOW'S LAKE FUTURE

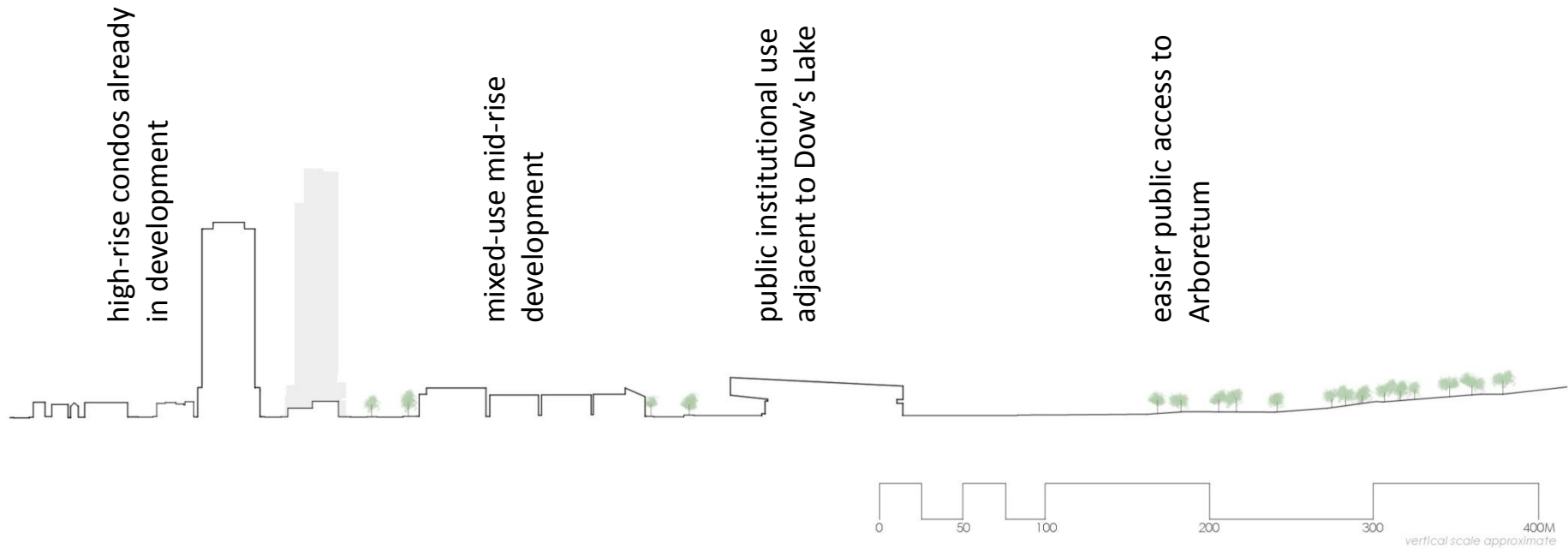

LAND USE & BUILT FORM

SPECIAL AREAS NORTH OF DOW'S LAKE

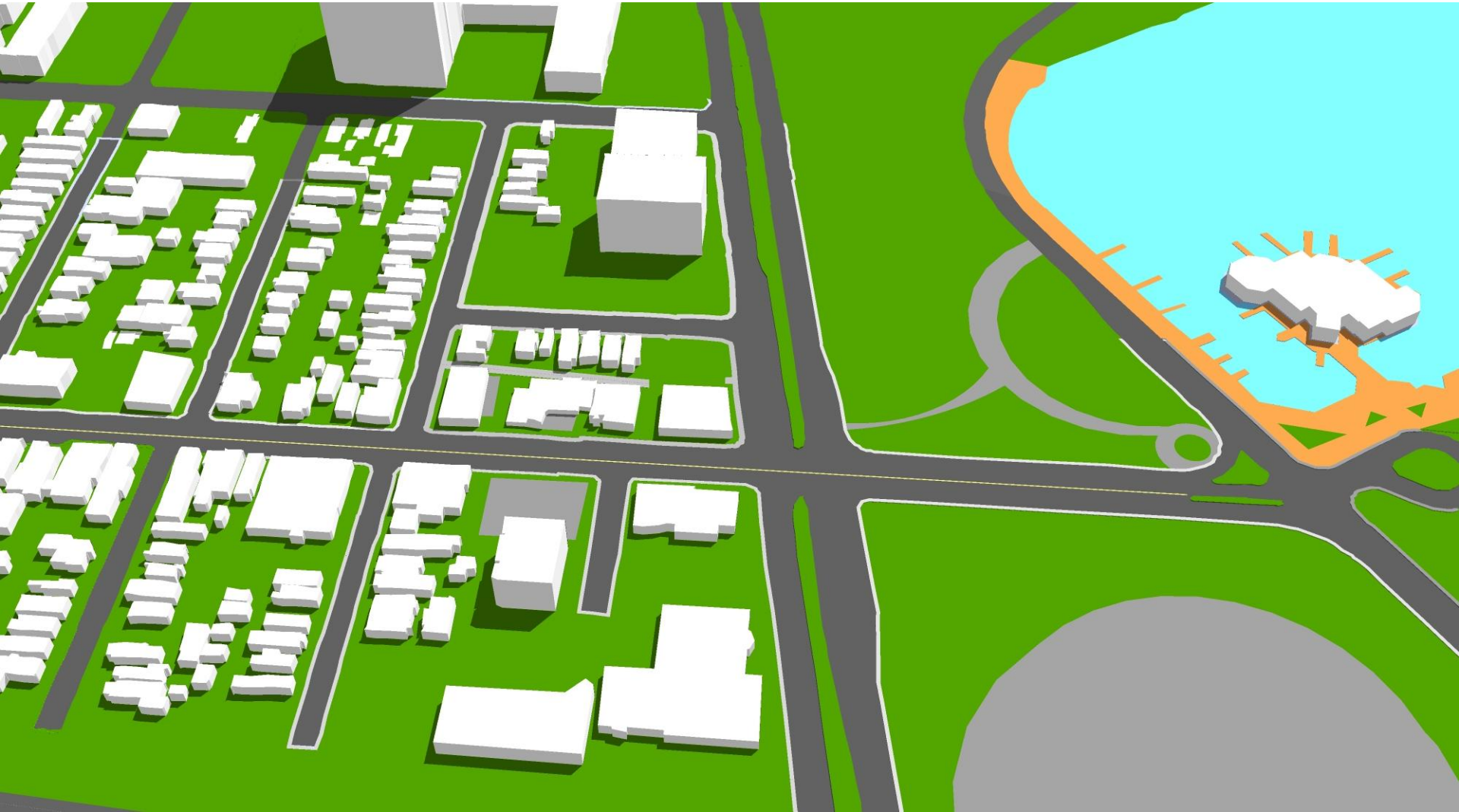

LAND USE & BUILT FORM

SPECIAL AREAS NORTH OF DOW'S LAKE



COMPREHENSIVE APPROACH

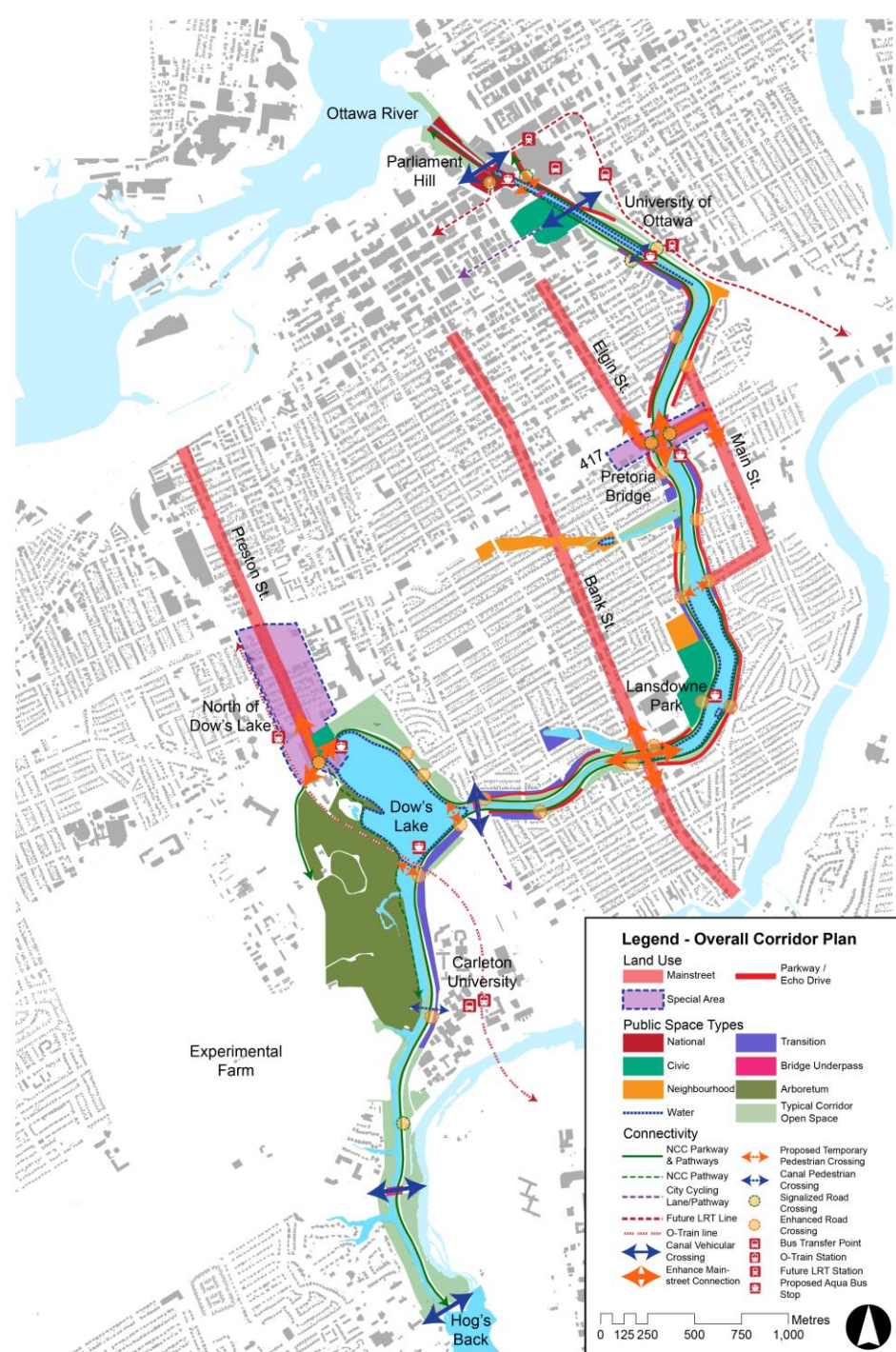



CONCLUSION

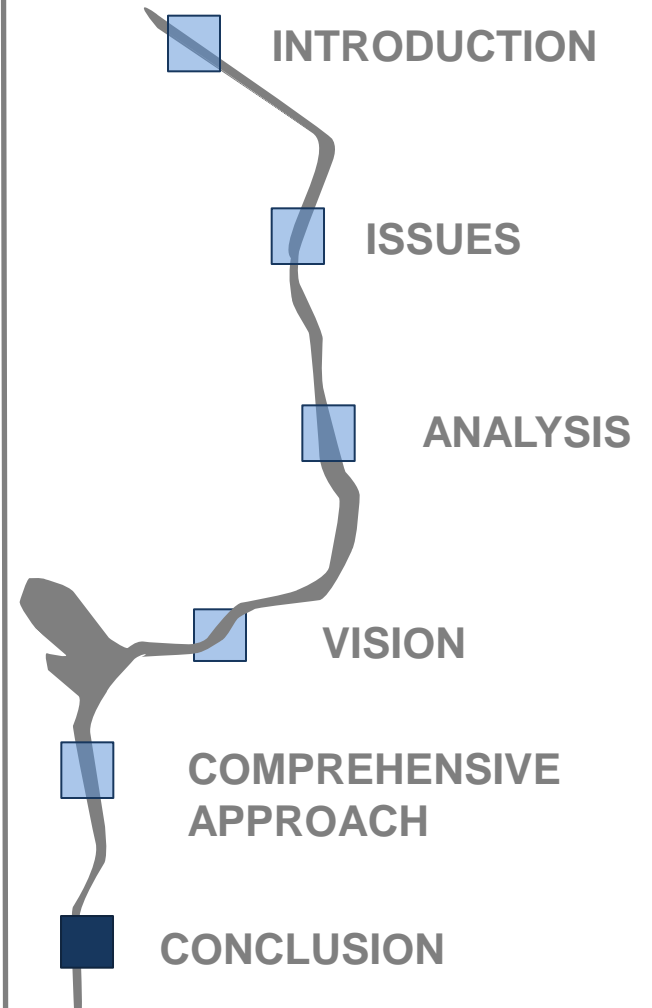

CONCLUSION

MAKE THE CANAL A
PRIORITY

DEVELOP
PARTNERSHIPS

FOCUS ON
PLACE-MAKING

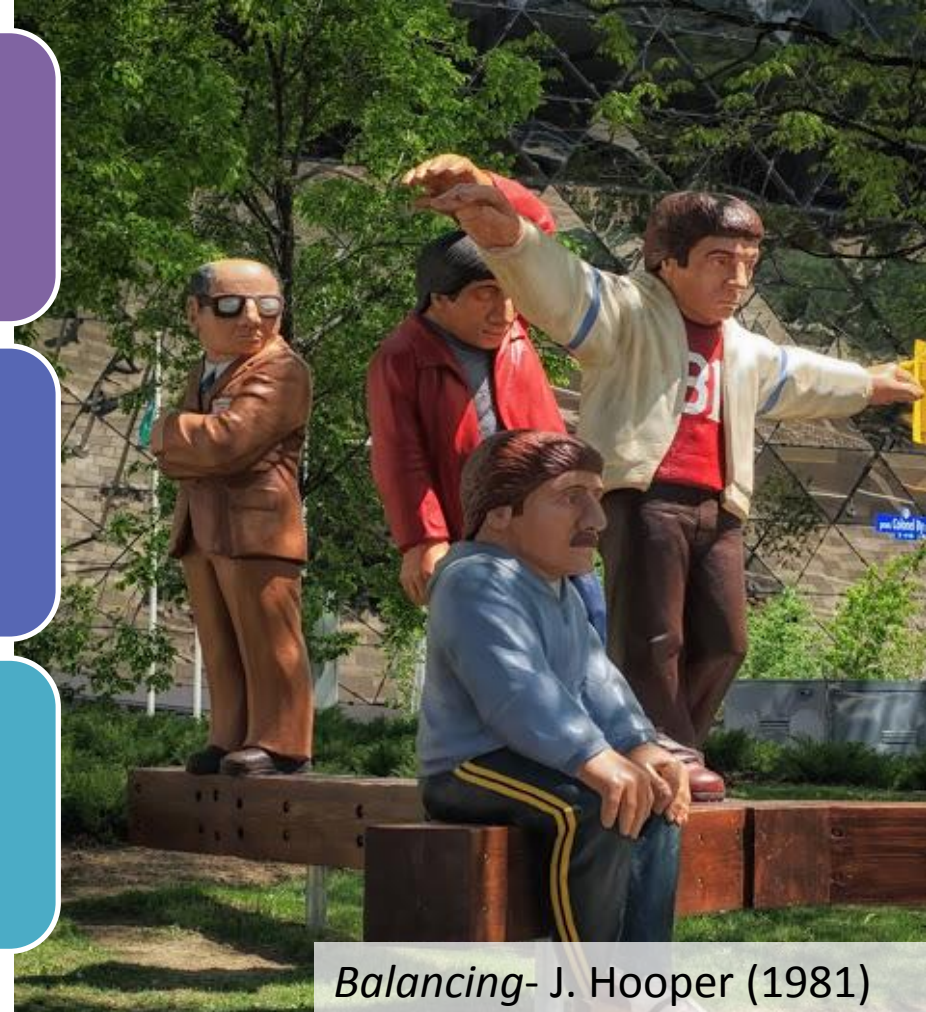

Balancing- J. Hooper (1981)



Stephen Bohan Jacob Bolduc Arthur Grabowski Ben Holthof Golsa Kheir-Moghadam
Fraser McLeod Mattson Meere Jeff Nadeau Ryan Poulton Jason Sands David Westbrook

Photo: Opentravel. (2013)